



## Visualization of Settings

The sub screen (label) shows the item to be set.

**New PFG300** **Current model**

Always displayed on one screen

Switches between displays

**Mode Examples**

**Hysteresis mode**

Normal output    Set value (Threshold value)    Reverse output    Set value (Threshold value)    Hysteresis    Set hysteresis value

**Window comparator mode**

Normal output/Lo side    Set value (Threshold value)    Normal output/Hi side    Set value (Threshold value)    Reverse output/Lo side    Set value (Threshold value)    Reverse output/Hi side    Set value (Threshold value)

## Easy Screen Switching

It is possible to change the settings while checking the measured value.

**Main screen**  
Measured value (Current flow value)

**Sub screen/Left side**  
Label (Display item)

**Sub screen/Right side**  
Set value (Threshold value)

The sub screen can be switched by pressing the up/down buttons.



\* Either "Input of line name" or "Display OFF" can be added via the function settings.

## NPN/PNP Switch Function

The number of stock items can be reduced.

Select NPN or PNP

**NPN**      **PNP**

## Analog output of 0 to 10 V is also available.

Voltage output	1 to 5 V	Switchable
	0 to 10 V	
Current output	4 to 20 mA	Fixed

## Input Range Selection (for Pressure/Flow rate)

The displayed value to the sensor input can be set as required.  
(Voltage input: 1 to 5 V/Current input: 4 to 20 mA)

Pressure switch/Flow switch can be displayed.

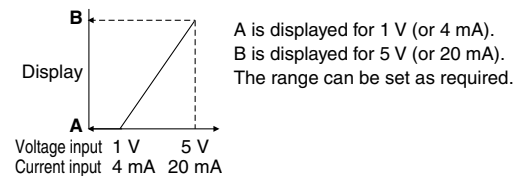

### ■ Pressure Sensor for General Fluids/PSE570

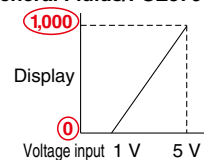

	A	B
PSE570	0	1,000
PSE573	-100	100
PSE574	0	500

Set A and B to the values shown in the table above.

## Functions

- Output operation
- Simple setting mode
- Display color
- Delay time setting
- Digital filter setting
- FUNC output switching function
- Selectable analog output function
- External input function
- Forced output function
- Accumulated value hold
- Peak/Bottom value display
- Setting of security code
- Keylock function
- Reset to the default settings
- Display with zero cut-off setting
- Selection of display on sub screen
- Analog output free range function
- Error display function
- Copy function
- Power-saving mode

## Simple 3-Step Setting

When the S button is pressed and the set value (P\_1) is being displayed, the set value (threshold value) can be set. When the S button is pressed and the hysteresis (H\_1) is being displayed, the hysteresis value can be set.

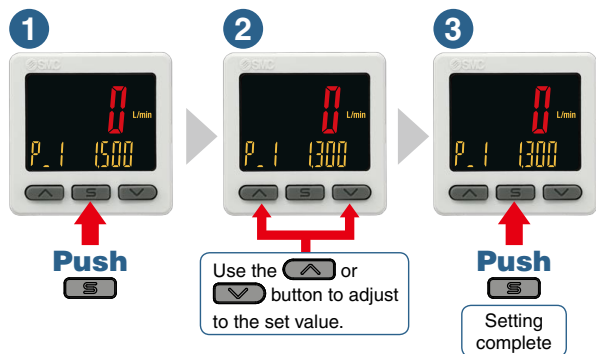

### With a snap shot function for set value reading

Pressing the  $\uparrow$  and  $\downarrow$  buttons simultaneously for a minimum of 1 second will make the set value (threshold value) the same as the current flow value.

**Snap shot function**

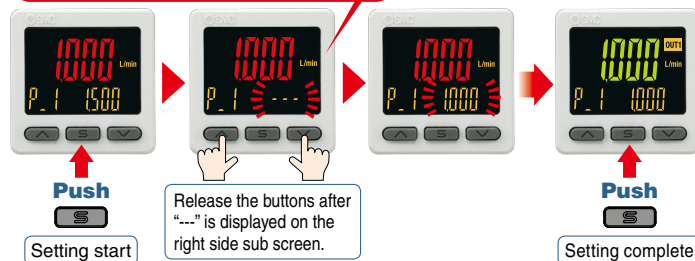

## Convenient Functions

### ● Copy function

The settings of the master monitor can be copied to the slave monitors.

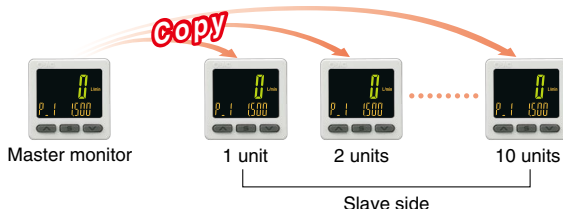

### ● Secret code setting function

The key locking function keeps unauthorized persons from tampering with the settings.

### ● Power-saving function

Power consumption is reduced by turning off the monitor.

Current consumption*1	Reduction rate*2
25 mA or less	Approx. 50% reduction

\*1 During normal operation \*2 In power-saving mode

### ● External input function

The accumulated value, peak value, and bottom value can be reset remotely.

## Compact & Lightweight

● Compact: Max. 6 mm shorter

● Lightweight: Max. 5 g lighter (30 g → 25 g)

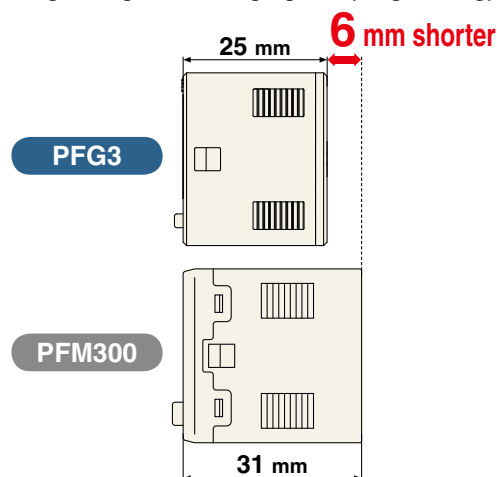

## Mounting

Bracket configuration allows for mounting in four orientations.

Bracket A

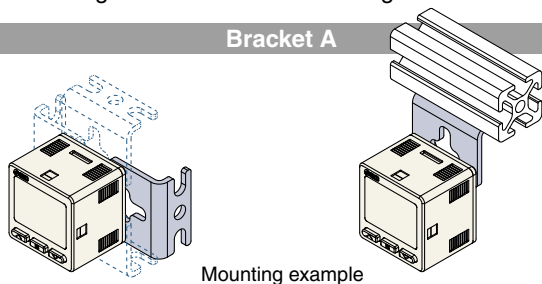

Bracket B

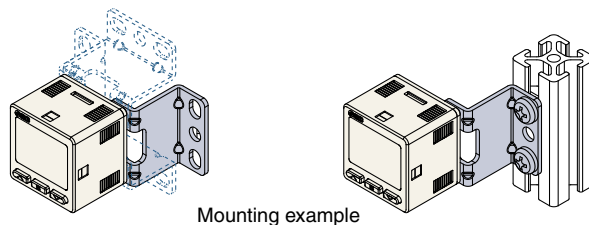

Panel mount

Mountable side by side without clearance

### One opening!

- Reduced panel fitting labor
- Space saving

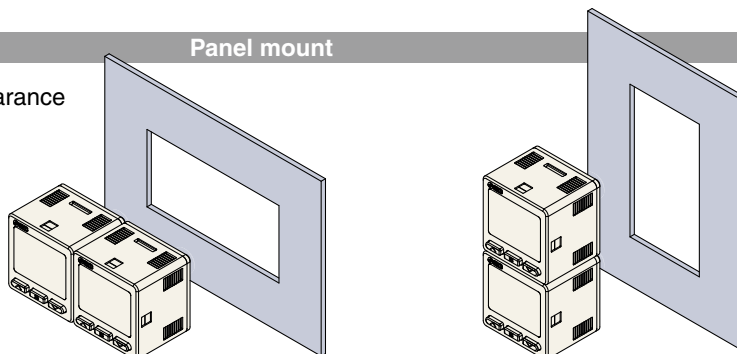

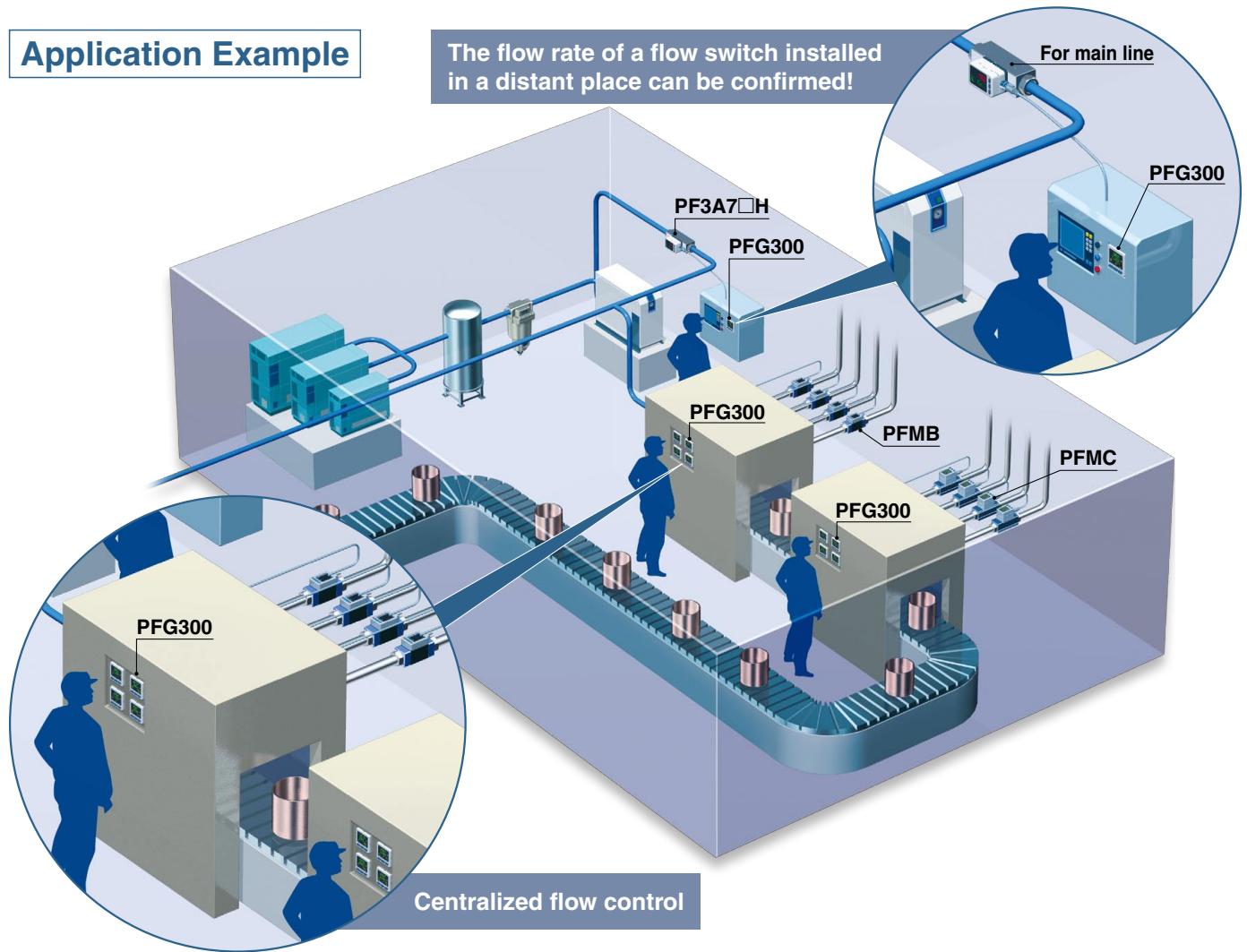

## Application Example

The flow rate of a flow switch installed in a distant place can be confirmed!



## Applicable Flow Switch Variations

Series	Enclosure	Applicable fluid	Rated flow range	Display
<b>PFMB</b> 	IP40	Dry air, N <sub>2</sub>	2 to 200 L/min	2-color LED display
 <a href="#">Click here for the catalog (PDF).</a>			5 to 500 L/min 10 to 1000 L/min 20 to 2000 L/min	2-color LCD display
<b>PFMC</b> <a href="#">Click here for the catalog (PDF).</a>	IP65	Dry air, N <sub>2</sub>	5 to 500 L/min 10 to 1000 L/min 20 to 2000 L/min	3-color LCD display
 <b>PF3A7□H</b> <a href="#">Click here for the catalog (PDF).</a>	IP65	Air, N <sub>2</sub>	30 to 3000 L/min 60 to 6000 L/min 120 to 12000 L/min	3-color LCD display